

The iDeal Butt Hinge for Composite Doors is simple-to-fit, fully adjustable, offers proven reliability & is available in a choice of 7 weather-resistant finishes.

Mila Hardware has been the UK's leading distributor of hardware to the replacement window & door industry for over 30 years. Our comprehensive product range includes our own innovative Mila brand products, designed & developed in-house, as well as other market-leading brands enabling us to offer value, mid-range & premium product solutions to every customer, for almost any application, in every market sector.



- Lateral & vertical adjustment for easy installation
- Compression adjustment
- Adjustment achieved with an allen key without need to dis-mount door leaf
- Steel hinge pin for added strength, held in place with security grub screw
- Operational reliability - tested to 50,000 cycles
- Weather resistant - tested to 480 hours salt spray
- Meets the requirements of Secured by Design
- 7 finishes including contemporary smokey chrome & satin chrome
- Suitable for composite doors & non over-rebated doors
- Simple-to-fit
- Hinge cover strip available for composite doors
- Suites with other Mila door furniture

call our sales
team today on

01327 312 400

visit us
today at

www.mila.co.uk



order before 5pm for next day delivery

Part of the iDeal Butt Hinge range - simple-to-fit, slim design & in seven colour options.



Above: iDeal butt hinge for composite doors shown polished chrome, polished gold, smokey chrome, satin chrome, white, light oak & brown.

iDeal Butt Hinge for Composite Doors

The iDeal butt hinge for composite doors has been developed in-house by Mila's product design team. The hinge has a slim design and is also suitable for non over-rebated doors. Available in a choice of 7 colour finishes including contemporary smokey chrome and satin chrome, all finishes suite with other Mila door and window furniture.

The hinge is manufactured from high performance zinc and aluminium alloy and is compression adjustable (+2mm) to ensure weather tightness whilst lateral adjustment (+/-2mm) and vertical

adjustment (+4mm) ensure ease of installation.

To speed both fabrication in-factory and installation on-site adjustment can be achieved without dis-mounting the door leaf.

A steel hinge pin enhances strength and is secured in place with a security grub screw. 8mm diameter bosses provide additional stability. 3 iDeal butt hinges will hold a door sash of up to 80kg.

The iDeal butt hinge for composite

doors has been independently tested to both PAS 023 and PAS 024 at the UKAS accredited Mila Test Centre and also meets the requirements of Secured by Design. The hinge has achieved 50,000 cycles underload to ensure operational reliability and 480 hours salt spray for optimum weather resistance.

Jigs are also available to suit this product.

Hinge cover strips & colour-coded composite door locks are available to suit this product. Call us today for more info.

Technical Specification

Type	Butt hinge for composite & non-rebated doors
Material	Zinc and aluminium alloy
Hinge Pin	Steel, 6mm
Lateral Adj.	+/- 2mm
Vertical Adj.	+4mm
Compression Adj.	+2mm
Max Sash Weight	80kg (3 hinges)
Fixing Bosses	8mm
Cycles	50,000
Salt Spray	240hrs (plated), 480hrs (powder coated)
Finishes	White, brown, light oak, polished gold, polished chrome, smokey chrome & satin chrome
Box Qty	30

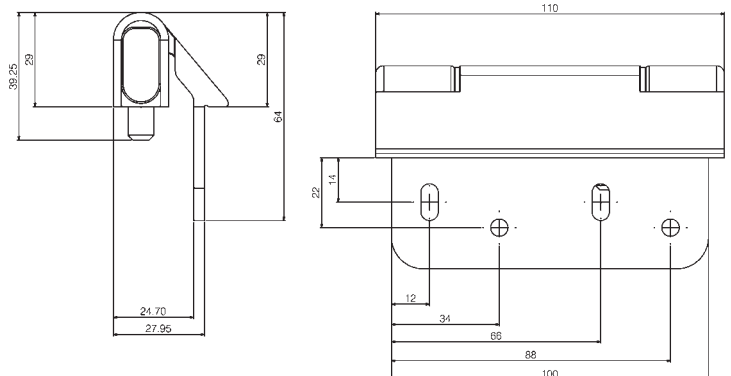

Part Numbers

Description	Polished Gold	Polished Chrome	Smokey Chrome	Satin Chrome	White	Brown	Light Oak
iDeal butt hinge for composite doors	022262	022264	022267	022266	022260	022261	022263
Jigs - 022524							

10 Mechanical Guarantee years
2 Labour Guarantee years
10 Surface Finish (powder coated) Guarantee years
5 Surface Finish (plated) Guarantee years



Mila
 1 Brunel Close, Drayton Fields Ind. Est.
 Daventry, Northamptonshire. NN11 8RB
 Mila Sales. 01327 312 400
 Web. www.mila.co.uk